

Salisbury Drive, Prestatyn, Denbighshire LL19 8DL

£185,000

2 1 1



This well presented detached bungalow is situated in a sought after residential location. The property offers a good size lounge/diner with picture window, fitted kitchen, bathroom and two double bedrooms. Having well maintained gardens with off road parking, early viewing is recommended. No forward Chain.

DIRECTIONS From the Prestatyn office turn left onto Meliden Road, right at the mini roundabout and immediate left onto Fforddisa, third right onto Canterbury Drive and and first left onto St Asaph Drive which leads onto Salisbury Drive and the property will be found by way of a 'For Sale' sign.

Key Features

- DETACHED BUNGALOW
- TWO DOUBLE BEDROOMS
- OFF ROAD PARKING
- NO FORWARD CHAIN
- EPC - tbc
- POPULAR RESIDENTIAL LOCATION
- SPACIOUS LOUNGE/DINER
- WELL MAINTAINED THROUGHOUT
- FREEHOLD
- COUNCIL TAX BAND - D

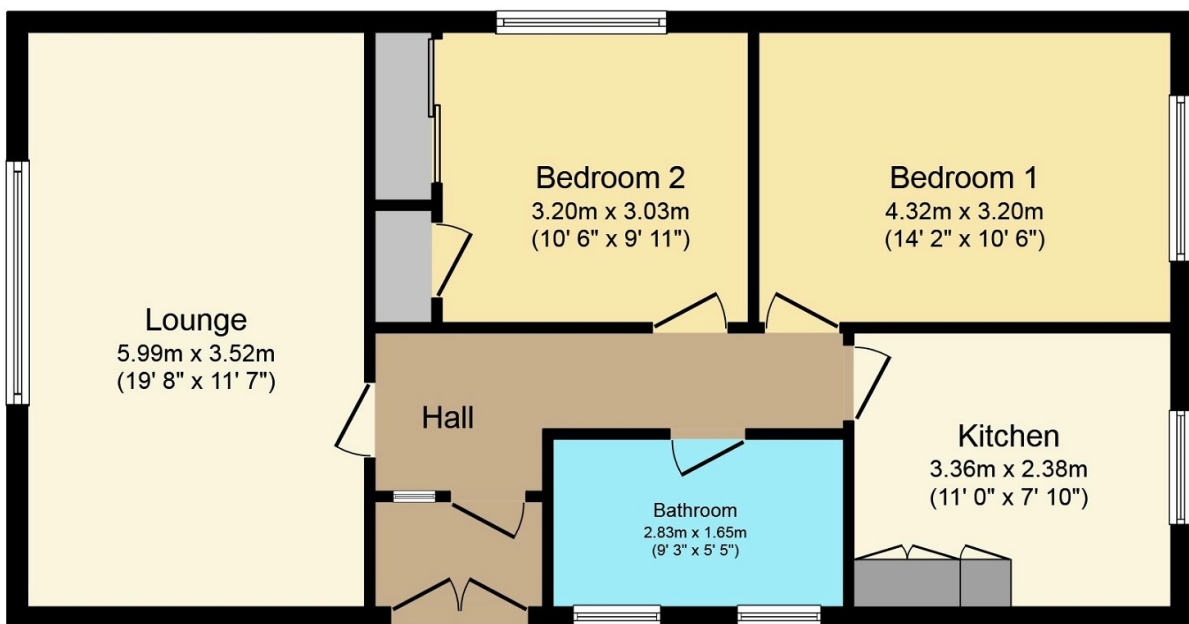

Floor Plan

Total floor area 71.4 m² (769 sq.ft.) approx

This plan is for illustration purposes only and may not be representative of the property. Plan not to scale. Powered by PropertyBox